

nassli
LED LIGHTS

LED DOWN LIGHT T18

Application:

It can be widely used for decoration, shopping malls, Palaces, Trade shows, Supermarkets, Conference Halls, Hotels, Schools, Hospitals, Meeting room Factories, Theater, Cinemas, Kitchens and Corridor etc...

Feature:

The product used as pure light source , using LED technology human and environment friendly,no PB, Hg nor UV.
High power saving fixture, no decay and color temperature shift.
Can be dimmable (through direct control or via network).



SPECIFICATIONS

ITEM	DESCRIPTION
Input Voltage	220 - 240 V A C
Frequency	50 / 60 H z
Power factor	>98%
CCT	2700K, 3000K, 4000K, 6000K
CRI	>83%
LED Efficiency	110-120Lm/W
Power supply	Tridonic / Nassli
LED Type	Osram / Epistar
Materials	Aluminum, PC, & Friendly material
Beam Angle	160°
Life Time	>50,000 Hour
Operating Temp	-20°C to +55°C
Storage Temp	-40°C to +65°C
Certifications	CE, SELV and ISO
Mounting	Recessed
IP Rating	IP20
Dimmable	On Request
Emergency	On Request
Warranty	5 Years

Order code	Dimensions(mm)	Power(Watt)	Lumen
NSL-DLT18-4-15W-XXK-SMD-NS-XX-IP20	W130 H66 Ø115	15	1650
NSL-DLT18-4-15W-XXK-SMD-NS-XX-IP44	W130 H66 Ø115	15	1650
NSL-DLT18-4-15W-XXK-SMD-TD-XX-IP20	W130 H66 Ø115	15	1650
NSL-DLT18-4-15W-XXK-SMD-TD-XX-IP44	W130 H66 Ø115	15	1650

NASSLI LED Factory C.R. 1010328884
www.nassli-led.com.sa Kingdom of Saudi Arabia
Riyadh (Head Office), P.O. Box25320 Riyadh 11466, UN: 920004733

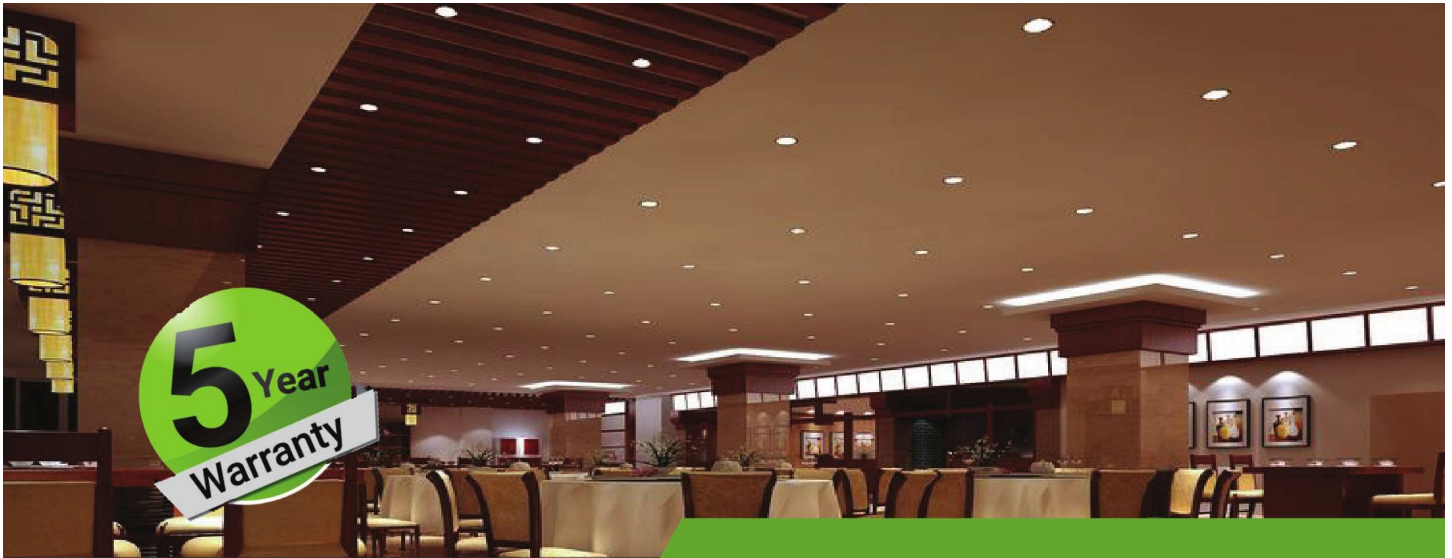

nassli
LED LIGHTS

LED DOWN LIGHT T18

Application:

It can be widely used for decoration, shopping malls, Palaces, Trade shows, Supermarkets, Conference Halls, Hotels, Schools, Hospitals, Meeting room Factories, Theater, Cinemas, Kitchens and Corridor etc...

Feature:

The product used as pure light source, using LED technology human and environment friendly, no PB, Hg nor UV.

High power saving fixture, no decay and color temperature shift.

Can be dimmable (through direct control or via network).



SPECIFICATIONS

ITEM	DESCRIPTION
Input Voltage	220 - 240 V A C
Frequency	50 / 60 H z
Power factor	>98%
CCT	2700K, 3000K, 4000K, 6000K
CRI	>83%
LED Efficiency	110-120Lm/W
Power supply	Tridonic / Nassli
LED Type	Osram / Epistar
Materials	Aluminum, PC, & Friendly material
Beam Angle	160°
Life Time	>50,000 Hour
Operating Temp	-20°C to +55°C
Storage Temp	-40°C to +65°C
Certifications	CE, SELV and ISO
Mounting	Recessed
IP Rating	IP20
Dimmable	On Request
Emergency	On Request
Warranty	5 Years

Order code	Dimensions(mm)	Power(Watt)	Lumen
NSL-DLT18-4-20W-XXK-SMD-NS-XX-IP20	W130 H66 Ø115	20	2200
NSL-DLT18-4-20W-XXK-SMD-NS-XX-IP44	W130 H66 Ø115	20	2200
NSL-DLT18-4-20W-XXK-SMD-TD-XX-IP20	W130 H66 Ø115	20	2200
NSL-DLT18-4-20W-XXK-SMD-TD-XX-IP44	W130 H66 Ø115	20	2200

NASSLI LED Factory C.R. 1010328884
www.nassli-led.com.sa Kingdom of Saudi Arabia
Riyadh (Head Office), P.O. Box25320 Riyadh 11466, UN: 920004733

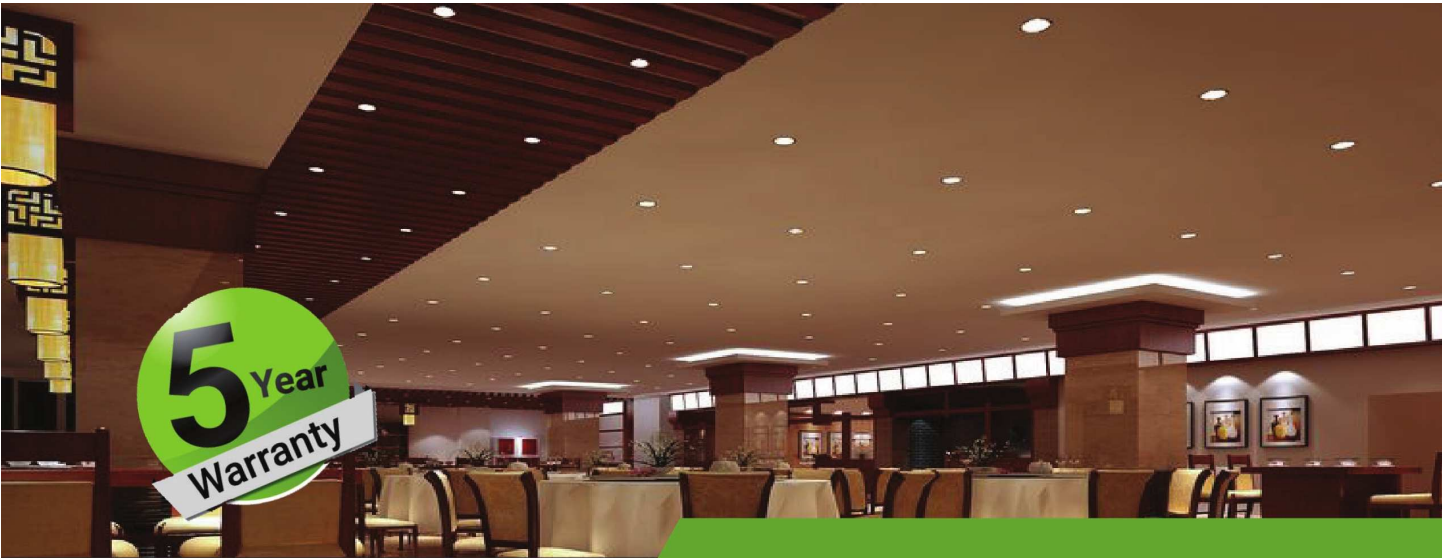

nassli
LED LIGHTS

LED DOWN LIGHT T18

Application:

It can be widely used for decoration, shopping malls, Palaces, Trade shows, Supermarkets, Conference Halls, Hotels, Schools, Hospitals, Meeting room Factories, Theater, Cinemas, Kitchens and Corridor etc...

Feature:

The product used as pure light source , using LED technology human and environment friendly,no PB, Hg nor UV.
High power saving fixture, no decay and color temperature shift.
Can be dimmable (through direct control or via network).

SPECIFICATIONS

ITEM	DESCRIPTION
Input Voltage	220 - 240 V A C
Frequency	50 / 60 H z
Power factor	>98%
CCT	2700K, 3000K, 4000K, 6000K
CRI	>83%
LED Efficiency	110-120Lm/W
Power supply	Tridonic / Nassli
LED Type	Osram / Epistar
Materials	Aluminum, PC, & Friendly material
Beam Angle	160°
Life Time	>50,000 Hour
Operating Temp	-20°C to +55°C
Storage Temp	-40°C to +65°C
Certifications	CE, SELV and ISO
Mounting	Recessed
IP Rating	IP20
Dimmable	On Request
Emergency	On Request
Warranty	5 Years



Order code	Dimensions(mm)	Power(Watt)	Lumen
NSL-DLT18-4-18W-XXK-SMD-NS-XX-IP20	W130 H66 Ø115	18	1980
NSL-DLT18-4-18W-XXK-SMD-NS-XX-IP44	W130 H66 Ø115	18	1980
NSL-DLT18-4-18W-XXK-SMD-TD-XX-IP20	W130 H66 Ø115	18	1980
NSL-DLT18-4-18W-XXK-SMD-TD-XX-IP44	W130 H66 Ø115	18	1980